

EXCELLENS T

standard duct

- cod. 11120060 - cod. 11120072 - cod. 11120010
- cod. N11120060 - cod. N11120072 - cod. N11120010
- cod. E11120060 - cod. E11120072 - cod. E11120010
- cod. SCD100006 - cod. SCD100008 - cod. SCD100617
- cod. SCD100618 - cod. SCD100051 - cod. SCD100053
- cod. SCD100608 - cod. SCD100609 - cod. SCD100184
- cod. SCD100619 - cod. SCD100623

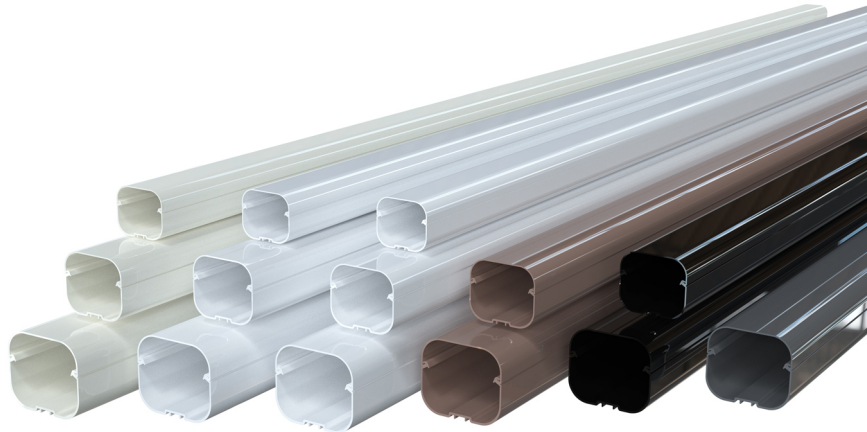

TECHNICAL SPECIFICATIONS:

- Impact-resistant and UV-resistant plastic material
- Rounded bottom and lid
- Clip-together central fastening
- Pre-punched slots in bottom for wall mounting
- Prepared for insertion of the mini pumps Easy Flow, Easy One, Aqua Split (only model T 72-EXC)
- Length 2 m
- Paintable with light-colored paints
- Operating temperature -20°C / +60°C
- Models tested by a third-party laboratory; test reports are available on request or on the website (only for colored models)

OPERATING TEMPERATURES

- Operating temperature -20°C / +60°C
- Coloured operating temperature -20°C / +75°C

MODELS AVAILABLE:



TOP LINE -
IVORY



NEW LINE -
WHITE



ECO LINE -
PEARL GREY



BROWN LINE -
BROWN



BLACK LINE -
BLACK

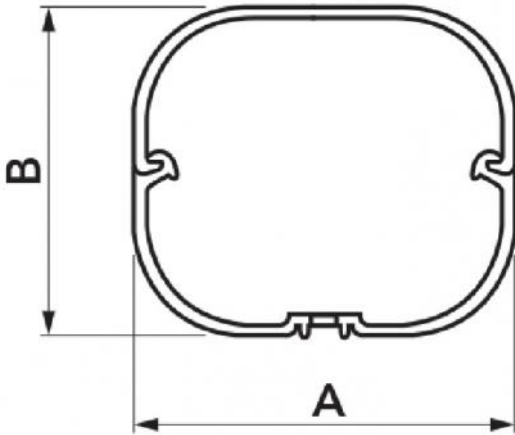

DIMENSIONS

CODE	MODEL	LINE	A [mm]	B [mm]
11120060	T 60 - EXC	TOP LINE	60	52
11120072	T 72 - EXC	TOP LINE	72	64
11120010	T 100 - EXC	TOP LINE	98	73
N11120060	T 60 - EXC	NEW LINE	60	52
N11120072	T 72 - EXC	NEW LINE	72	64
N11120010	T 100 - EXC	NEW LINE	98	73
E11120060	T 60 - EXC	ECO LINE	60	52
E11120072	T 72 - EXC	ECO LINE	72	64
E11120010	T 100 - EXC	ECO LINE	98	73
SCD100006	T 72 - EXC	BROWN LINE	72	64
SCD100008	T 100 - EXC	BROWN LINE	98	73
SCD100617	T 72 - EXC	BROWN LINE	72	64
SCD100618	T 100 - EXC	BROWN LINE	98	73
SCD100051	T 72 - EXC	BLACK LINE	72	64
SCD100053	T 100 - EXC	BLACK LINE	98	73
SCD100608	T 72 - EXC	BLACK LINE	72	64
SCD100609	T 100 - EXC	BLACK LINE	98	73
SCD100184	T 72 - EXC	GREY LINE	72	64
SCD100619	T 72 - EXC	GREY LINE	72	64
SCD100623	T 100 - EXC	GREY LINE	98	73

ITEMS

CODE	DESCRIPTION
11120060	"EXCELLENS T" STANDARD TRUNKING - 2 mt. long - TOP LINE - T 60-EXC
11120072	"EXCELLENS T" STANDARD TRUNKING - 2 mt. long - TOP LINE - T 72-EXC
11120010	"EXCELLENS T" STANDARD TRUNKING - 2 mt. long - TOP LINE - T 100-EXC
N11120060	"EXCELLENS T" STANDARD TRUNKING - 2 mt. long - NEW LINE WHITE - T 60-EXC
N11120072	"EXCELLENS T" STANDARD TRUNKING - 2 mt. long - NEW LINE WHITE - T 72-EXC
N11120010	"EXCELLENS T" STANDARD TRUNKING - 2 mt. long - NEW LINE WHITE - T 100-EXC
E11120060	"EXCELLENS T" STANDARD TRUNKING - 2 mt. long - ECO LINE - T60-EXC
E11120072	"EXCELLENS T" STANDARD TRUNKING - 2 mt. long - ECO LINE - T72-EXC
E11120010	"EXCELLENS T" STANDARD TRUNKING - 2 mt. long - ECO LINE - T100-EXC
SCD100006	TRUNKING "EXCELLENS" T 72-EXC - BROWN LINE" - T 72-EXC
SCD100008	TRUNKING "EXCELLENS" T100-EXC - BROWN LINE" - T 100-EXC
SCD100617	TRUNKING "EXCELLENS" T 72-EXC - BROWN LINE" - T 72-EXC
SCD100618	TRUNKING "EXCELLENS" T100-EXC - BROWN LINE" - T 100-EXC
SCD100051	TRUNKING "EXCELLENS" T 72-EXC - BLACK LINE" - T 72-EXC
SCD100053	TRUNKING "EXCELLENS" T 100-EXC - BLACK LINE" - T 100-EXC
SCD100608	TRUNKING "EXCELLENS" T 72-EXC - BLACK LINE" - T 72-EXC
SCD100609	TRUNKING "EXCELLENS" T 100-EXC - BLACK LINE" - T 100-EXC
SCD100184	TRUNKING "EXCELLENS" T 72-EXC - GREY LINE" - T 72-EXC
SCD100619	TRUNKING "EXCELLENS" T 72-EXC - GREY LINE" - T 72-EXC
SCD100623	TRUNKING "EXCELLENS" T 100-EXC - GREY LINE" - T 100-EXC

All rights relating to this publication are the exclusive property of Tecnosystemi SpA.
Tecnosystemi SpA reserves the right to make changes at any time and without notice, for technical or commercial needs.

