

Safety and check valve without lever for fluids

- cod. SGC500011



TECHNICAL SPECIFICATIONS:

- Body in CW617N brass
- Stainless steel springs AISI 302
- Nominal pressure from 6 to 10 bar
- Range tolerance $\pm 5\%$
- Operating temperature: $0^{\circ}\text{C} \div +95^{\circ}\text{C}$
- Efflux coefficient 0.05
- Inlet / outlet connections G 1/2" ; M - G 1/2" ; F
- Suitable for use with Glycol and Water

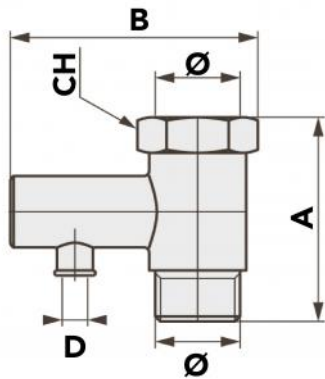

DIMENSIONS

CODE	A [mm]	B [mm]	CH [mm]	D [mm]	Ø
SGC500011	41	52	25	5	1/2"

CONFORMITY

Product compliant with Directive 2014/68/EU (PED)

ITEMS

CODE	DESCRIPTION
SGC500011	WP142 SAFETY AND NON-RETURN VALVE FOR FLUIDS W/O DRAIN LEVER

All rights relating to this publication are the exclusive property of Tecnosystemi SpA.
 Tecnosystemi SpA reserves the right to make changes at any time and without notice, for technical or commercial needs.