

# 45° elbow in EPS for MVHR Ø125 / Ø160

- cod. ACC600039 - cod. ACC600040



## TECHNICAL SPECIFICATIONS MOD. Ø 125

- Grey colour EPS insulated elbow
- Wall thickness: 15.5mm
- Weight: 0,15 kg
- Dimensions: 189 x 156 x 196 mm
- internal Ø: 125 mm
- Temperature range -25 / +80 (C°)
- Maximum air flow: 275 m<sup>3</sup>/h
- Thermal resistance: 0.032 m<sup>2</sup>K/W

## TECHNICAL SPECIFICATIONS MOD. Ø 160

- Grey colour EPS insulated elbow
- Wall thickness: 15.5mm
- Weight: 0,18 kg
- Dimensions: 218 x 191 x 208 mm
- internal Ø: 160 mm
- Temperature range -25 / +80 (C°)
- Maximum air flow: 425 m<sup>3</sup>/h
- Thermal resistance: 0.032 m<sup>2</sup>K/W

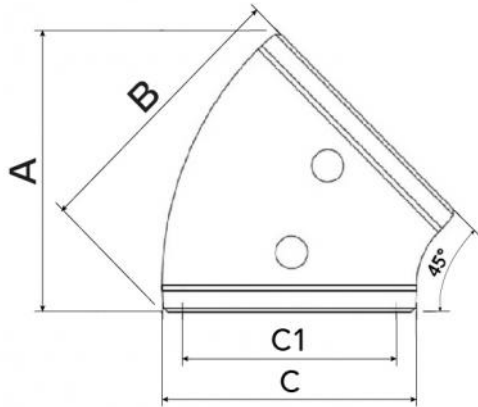

## DIMENSIONS

CODE	A [mm]	B [mm]	C [mm]	C1 [mm]
ACC600039	196		156	125
ACC600040	208		191	160

## GRAFICO PERDITE DI PRESSIONE

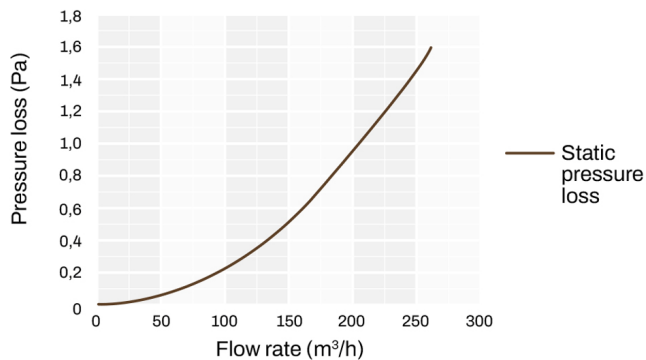

## ITEMS

CODE	DESCRIPTION
ACC600039	45° ELBOW IN EPS FOR MVHR Ø125
ACC600040	45° ELBOW IN EPS FOR MVHR Ø160

All rights relating to this publication are the exclusive property of Tecnosystemi SpA.  
 Tecnosystemi SpA reserves the right to make changes at any time and without notice, for technical or commercial needs.