

90° elbow in EPS for MVHR Ø125 / Ø160

- cod. ACC600037 - cod. ACC600038



TECHNICAL SPECIFICATIONS MOD. Ø 125

- Grey colour EPS insulated elbow
- Wall thickness: 15.5mm
- Weight: 0,2 kg;
- Dimensions: 278 x 156 x 278 mm
- internal Ø: 125 mm
- Temperature range -25 / +80 (C°)
- Maximum air flow: 275 m³/h
- Thermal resistance: 0.032 m²K/W

TECHNICAL SPECIFICATIONS MOD. Ø 160

- Grey colour EPS insulated elbow
- Wall thickness: 15.5mm
- Weight: 0,24 kg
- Dimensions: 295 x 191 x 295 mm
- internal Ø: 160 mm
- Temperature range -25 / +80 (C°)
- Maximum air flow: 425 m³/h
- Thermal resistance: 0.032 m²K/W

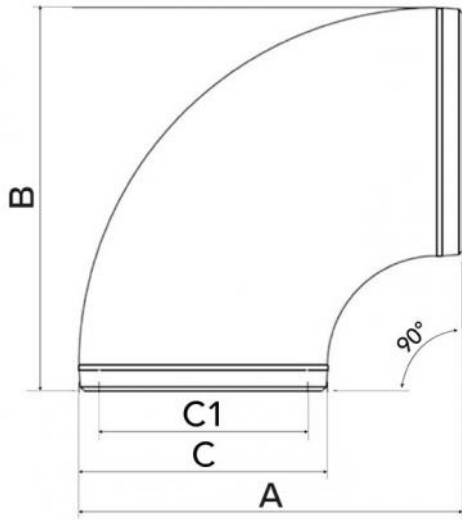

DIMENSIONS

CODE	A [mm]	B [mm]	C [mm]	C1 [mm]
ACC600037	278		156	125
ACC600038	295		191	160

GRAFICO PERDITE DI PRESSIONE

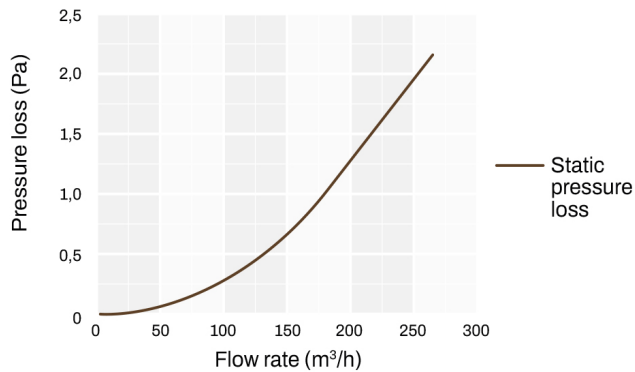

ITEMS

CODE	DESCRIPTION
ACC600037	90° ELBOW IN EPS FOR MVHR Ø125
ACC600038	90° ELBOW IN EPS FOR MVHR Ø160

All rights relating to this publication are the exclusive property of Tecnosystemi SpA.
 Tecnosystemi SpA reserves the right to make changes at any time and without notice, for technical or commercial needs.