

Mechanical circular bypass \varnothing 200 for plenum EOLO - EOLO MINI

- cod. GAD300006



DESCRIPTION

The bypass makes it possible to compensate the air flow out of the Eolo - Eolo Mini plenum, avoiding noise phenomena in the areas still open.

The by-pass, made of shockproof ABS, works by pushing excess air into the plenum.

The presence of adjustable counterweights will return it to position.

It is applied by slightly pressing on one of the two sides of the plenum.

Make sure the opening is facing downwards.

The counterweight is adjusted with multiple nuts screwed on the bolts.

DIMENSIONS

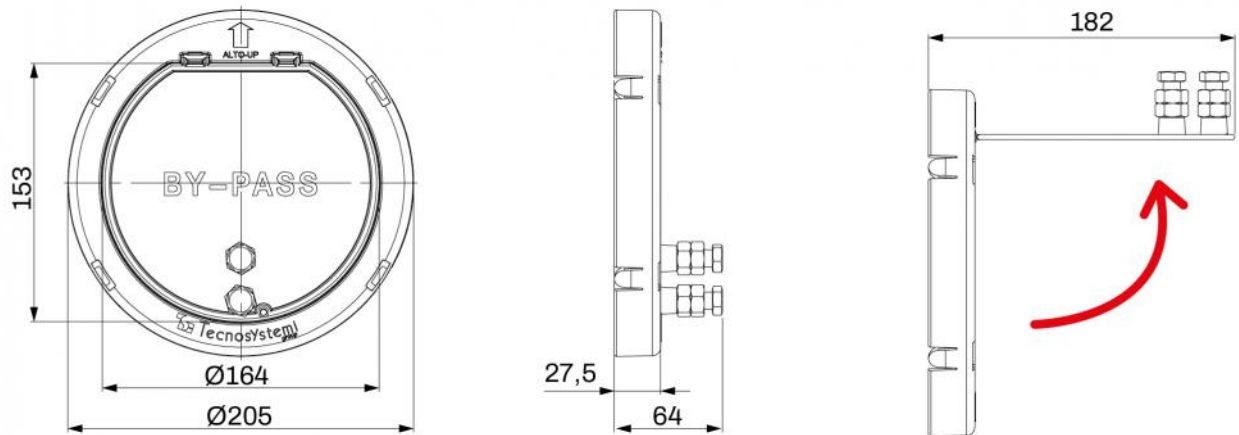

EXAMPLE OF INSTALLATION:

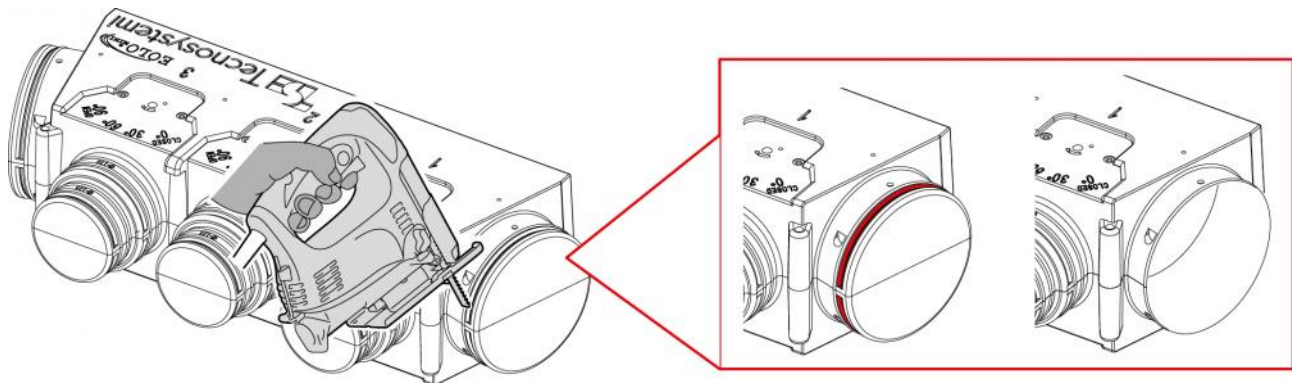

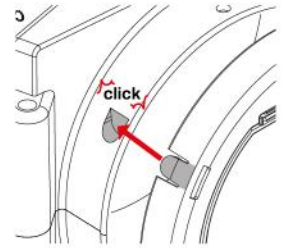
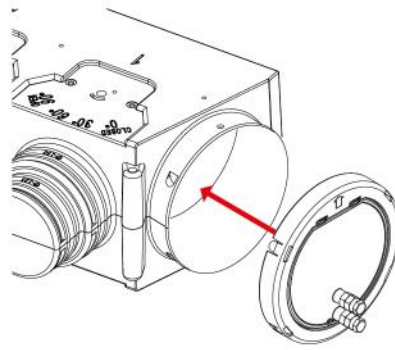
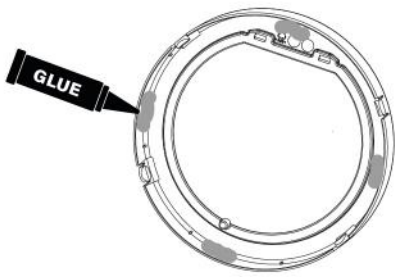

ITEMS

CODE	DESCRIPTION
GAD300006	PLÉNUM "EOLO" - "EOLO MINI" Ø 200

All rights relating to this publication are the exclusive property of Tecnosystemi SpA.
 Tecnosystemi SpA reserves the right to make changes at any time and without notice, for technical or commercial needs.