

# DATASHEET

rev. 00 - 29/11/2022

## Reduced sleeve F / F

26002800 - 26002810 - 26002820  
26002830



### TECHNICAL SPECIFICATIONS:

- Made of brass
- Application in hydraulics
- Gas thread
- Maximum operating temperature: +130°C

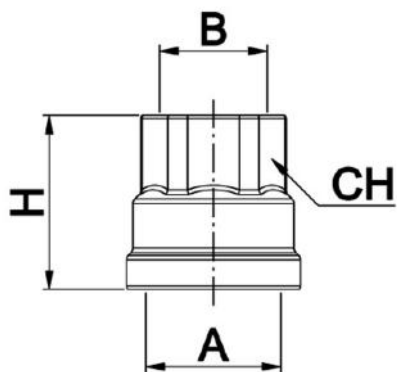

### DIMENSIONS

CODE	A	B	CH	H [mm]
26002800	1/2"	3/8"	17	28
26002810	3/4"	1/2"	25	29
26002820	1"	1/2"	26	33
26002830	1"	3/4"	30	37

## ITEMS

CODE	DESCRIPTION
26002800	
26002810	
26002820	
26002830	